

LED Shoebox Light

The Brightline Shoebox Light can now be installed by just one person. With the new split mount that locks together, installation time and effort is minimal.

FEATURES

Rotatable:

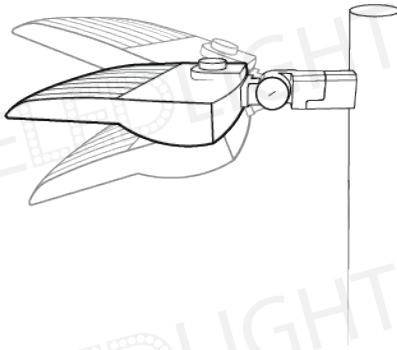

Interchangeable Caps:

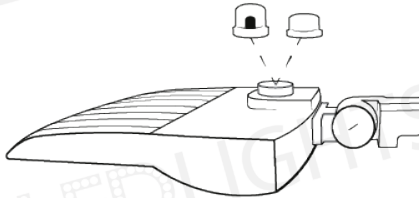

LED Shoebox Light: Slip Fitter Bracket

Installation Steps

Disconnect All Power

STEP 1

Install bracket to pole.
Tighten screws.

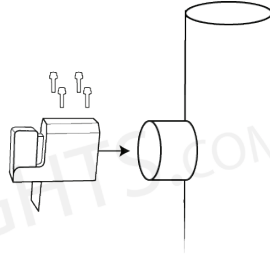

STEP 2

Install fixture to the bracket.
Tighten screws.

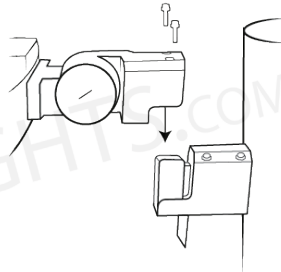

STEP 3

Connect AC wires of the fixture.
Close the cover of the bracket.

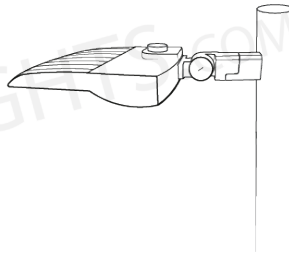

LED Shoebox Light: Direct Mount (Straight Bracket)

Installation Steps

Disconnect All Power

STEP 1

Install bracket to square pole.
Tighten screws.

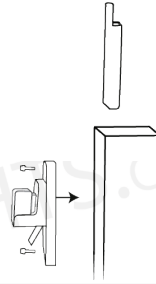

STEP 2

Install fixture to the bracket.
Tighten screws.

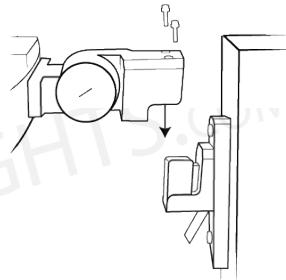

STEP 3

Connect AC wires of the fixture.
Close the cover of the bracket.

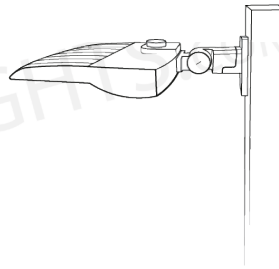

LED Shoebox Light: Direct Mount (Round Bracket)

Installation Steps

Disconnect All Power

STEP 1

Connect round attachment to direct mount bracket. Install bracket to round pole. Tighten screws.

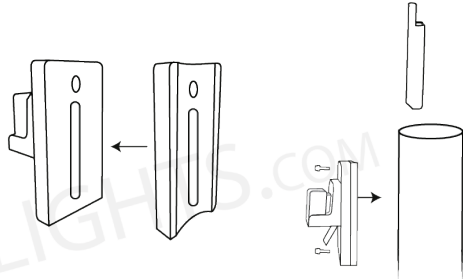

STEP 2

Install fixture to the bracket. Tighten screws.

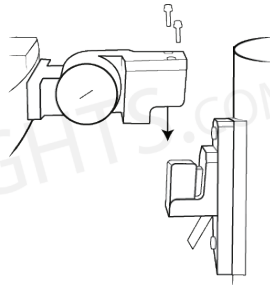

STEP 3

Connect AC wires of the fixture. Close the cover of the bracket.

